

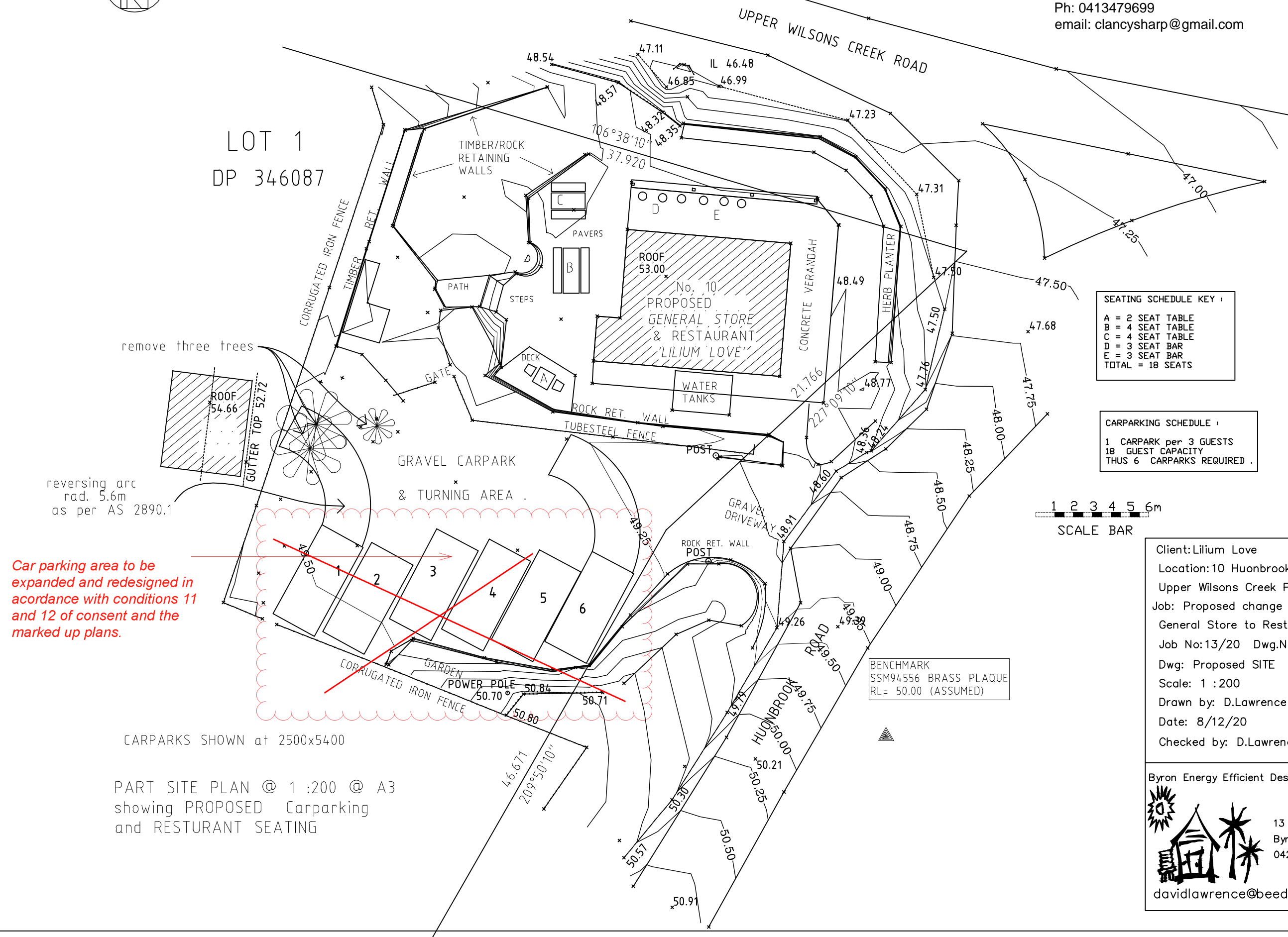

BASE TEMPLATE BY :

SURVEYOR: Clancy Sharp
24 Reserve Creek Road, Kielvale NSW 2484
Ph: 0413479699
email: clancyssharp@gmail.com

LOT 1
DP 346087



SEATING SCHEDULE KEY :

A = 2 SEAT TABLE
B = 4 SEAT TABLE
C = 4 SEAT TABLE
D = 3 SEAT BAR
E = 3 SEAT BAR
TOTAL = 18 SEATS

CARPARKING SCHEDULE :

1 CARPARK per 3 GUESTS
18 GUEST CAPACITY
THUS 6 CARPARKS REQUIRED .

1 2 3 4 5 6m
SCALE BAR

Client: Lilium Love
Location: 10 Huonbrook Road Rd
Upper Wilsons Creek Park
Job: Proposed change of Use from
General Store to Restaurant
Job No: 13/20 Dwg. No. 1 of 2
Dwg: Proposed SITE Plan
Scale: 1 : 200
Drawn by: D. Lawrence
Date: 8/12/20
Checked by: D. Lawrence

Byron Energy Efficient Design & Drafting

 13 Shelley Drive
Byron Bay. 2481
0423 531448
davidlawrence@beedad.com.au

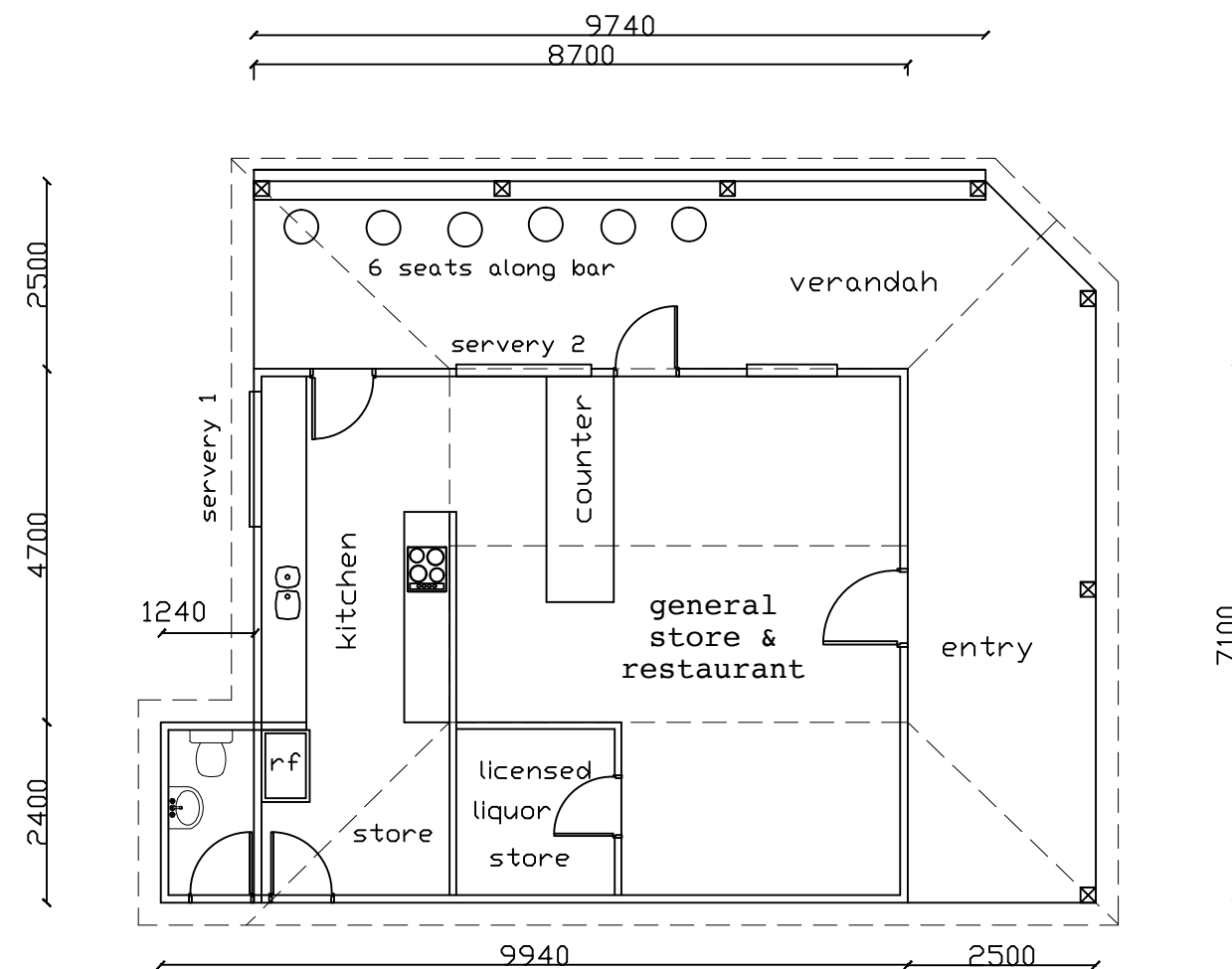
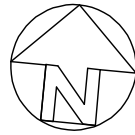

FLOOR PLAN @ 1 : 100 @ A3

showing 6 proposed outdoor restaurants seats attached to building.
refer to siteplan for balance of proposed seating locations (12 more seats)

Client: Lilium Love
Location: 10 Huonbrook Road Rd
Upper Wilsons Creek Park
Job: Proposed change of Use from
General Store to Restaurant
Job No: 13/20 Dwg.No. 2 of 2
Dwg: AS Built Floor plan
Scale: 1 : 100
Drawn by: D. Lawrence
Date: 8/12/20
Checked by: D. Lawrence

Byron Energy Efficient Design & Drafting



13 Shelley Drive
Byron Bay. 2481
0423 531448

davidlawrence@beedad.com.au